



LIVE THE ADVANTAGE

**DESKTOP
POWER
CENTER**

More Power No clutter.



INTRODUCTION

Wouldn't it be nice if you had the power to bring power to your workstations at home or office, without the added clutter of wires?

Legrand's Desktop Power Centers give you the power to do just that. A simple, smart, design solution where the units mount directly to surfaces like desks and tables, without unsightly clutter of wires ruining the nature of your work environment.

The elegant designs and colours of the Desktop Power Centers match and enhance the look of all types of work units.



FEATURES



The Desktop Power Centers have the unique ability of seamlessly blending into your spaces. The choice of White or Chic Grey as colour options bring a classic touch that goes with all kinds of workspaces.

Intelligent and energy efficient -
Smart charging capability recognizes devices and when to shut off during peak loads.

Switch & sockets are as per IS standards -
IS 1293/ IS 3954:1477

Easy connectivity to power sources -
1.5 meter cord with 3-pin plug

Child proof sockets (IP20 Rated) -
Smart socket mechanism, only allows a plug to be inserted when both of its pins are inserted simultaneously.

Lifelong reliability -
1 lakh guaranteed switch operations

Tested rigorously -
10,000 plug-ins and plug-outs

APPLICATIONS

Multiple mounting options -
Choose from options like above the table, under the table or on the wall.

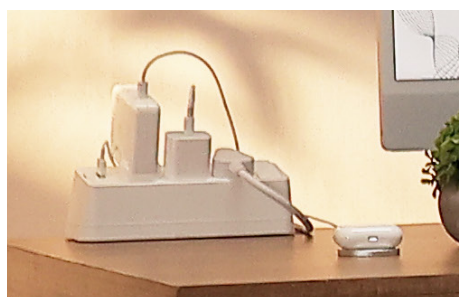

MOUNTING

Mounting the Desktop Power Centers is an easy task that comes with numerous flexible options.



Mount "on the desk" with the help of the Flat L-Bracket product facing up-ward direction. It can be installed on a table with a minimum thickness of 0.5 inches or more.



Mount "on the desk" & "under the desk" with the help of the Flat I-Bracket in reverse orientation. It can be installed on a table with a minimum thickness of 0.5 inches or more.



Mount "On the wall" with the help of the Wall Mount T-Bracket. It can be installed on any vertical surface.

The handy Mounting Kit included with the product includes options for both horizontal and vertical applications for any environment of usage.

Accessories come with three installation kits which includes three brackets respectively: Angle L-Bracket, Flat I-Bracket, and Wall Mount T-Bracket. The L-Bracket lets you install the product "On the Desk" with the product facing upward. It also allows you to install the product "Under the Desk" with the product facing forward. The Flat I-Bracket lets you install the product on the desk, but with the product facing forward. The T-Bracket lets you install the product "On the Wall" or any vertical surface.



PRODUCT SKUS



6 Module- Desktop Power Center along with L-Bracket mounting Kit:

This unit includes two (2) tamper-resistant power outlets and an optional (1) USB-A port. It comes with a 1.5-meter cord and a 3-pin plug for easy connection. The product includes and Angle L-Bracket allowing you to mount it "On The Desk" with the product facing upwards or "Under the Desk" facing forward. It is available in White and Chic Grey color options.



8 Module- Desktop Power Center along with L-Bracket mounting Kit:

This unit include three (3) tamper-resistant power outlets and an optional (1) USB-A port. It comes with a 1.5-meter chord and a 3-pin plug for easy connection. The product includes and Angle L-Bracket allowing you to mount it "On The Desk" with the product facing upwards or "Under the Desk" facing forward. It is available in White and Chic Grey color options.



UTILITY HOSPITALITY

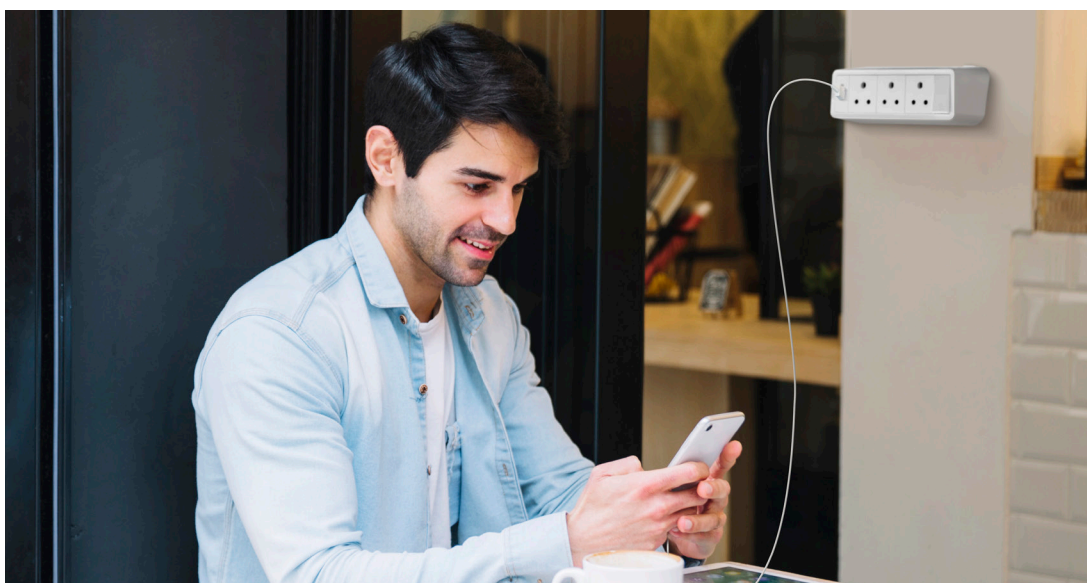
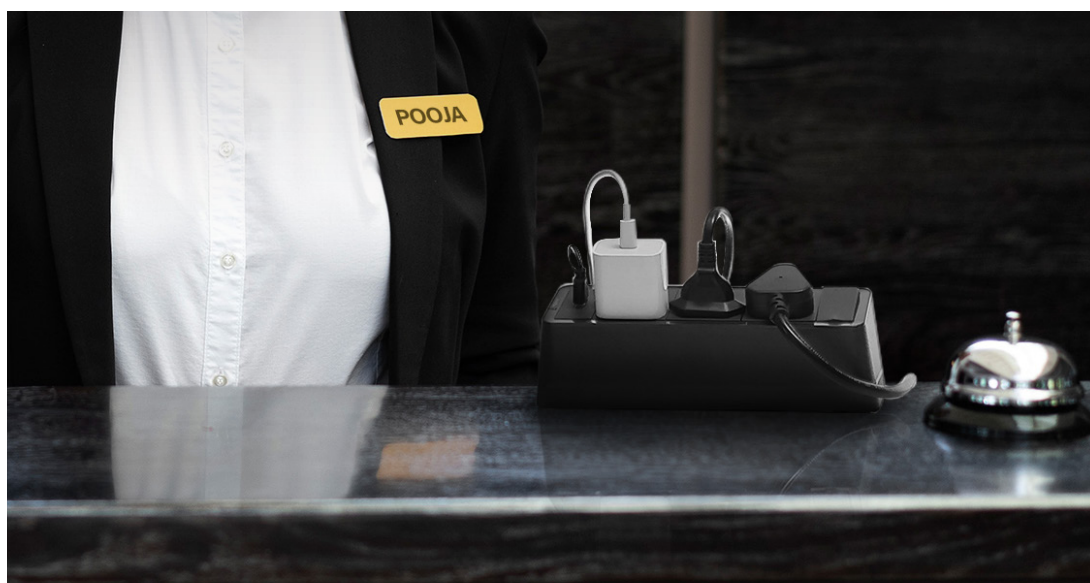

UTILITY WORK SPACE



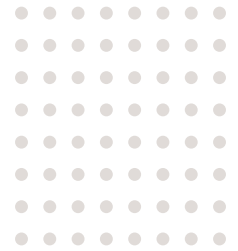

3-pin 6A Power outlets with a switch and one USB-A port

Technical Specifications

USB
 Input : 100-240V 50-60Hz/250 mA
 Output 5V -1500mA
 Power rating 1440W Max



**3 PIN Socket -
 6A 230V**

Cat. Nos	Desktop Power Center - White Finish	Pack
655020	6M-Desktop PC Socket - White With L bracket	1/5/20
655021*	6M-Desktop PC Socket+USB - White With L bracket	1/5/20
655022	8M-Desktop PC Socket - White With L bracket	1/5/20
655023*	8M-Desktop PC Socket+USB - White With L bracket	1/5/20



Cat. Nos	Desktop Power Center - Chic Grey Finish	Pack
655024	6M-Desktop PC Socket - Chic Grey With L bracket	1/5/20
655025*	6M-Desktop PC Socket+USB - Chic Grey With L bracket	1/5/20
655026	8M-Desktop PC Socket - Chic Grey With L bracket	1/5/20
655027*	8M-Desktop PC Socket+USB - Chic Grey With L bracket	1/5/20



*I and T brackets are to be purchased as additional accessories.



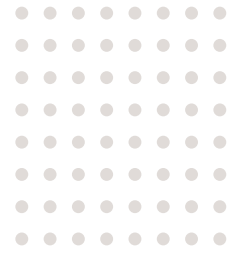

Accessories

Cat. Nos	Desktop Power Center - Empty Version To be equipped with Lyncus User Interface	Pack
655030	6M-Desktop PC Empty - White	1/5/20
655031	6M-Desktop PC Empty - Chic Grey	1/5/20
655032	8M-Desktop PC Empty - White	1/5/20
655033	8M-Desktop PC Empty - Chic Grey	1/5/20



*3 Pin plug and clamps are not part this cat reference and to be considered separately.

Cat. Nos	Desktop Power Center - Accessories	Pack
655036	Desktop PC Angle L - Bracket	1/10/60
655037*	Desktop PC Flat I - Bracket	1/10/60
655038*	Desktop PC Wall T - Bracket	1/10/60



*I and T brackets are to be purchased as additional accessories.



INSTALLATION INSTRUCTIONS

Bring power and charging right up to desks and tabletops. Desktop Power Centers are a smart, simple way of adding power and charging. The unit mounts directly to the surface, keeping the workspace free from cord clutter and creating a more organized and spacious environment. Elegant design and colours blend in nicely with any environment and the furniture within it.

This product is easy-to-install in various ways. You can use different accessories to mount it horizontally or vertically. These accessories offer several options, allowing you to mount the product on walls, under tables, or above tables in any setting.

Tools Required

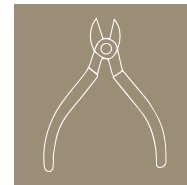

Cutter



Screwdriver

I Clamp – Above The Table

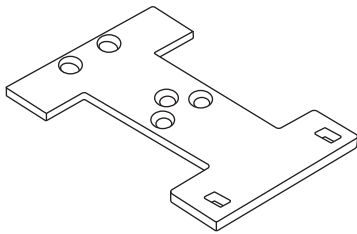

L Clamp – Under The Table/Over The Table

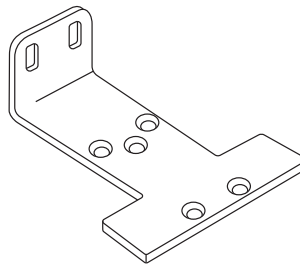

T Clamp – Wall Mount

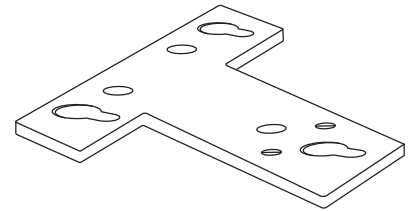

Step 1

Start by cutting both edges of highlighted portion in the drawings and gently bend them to detach from the product.

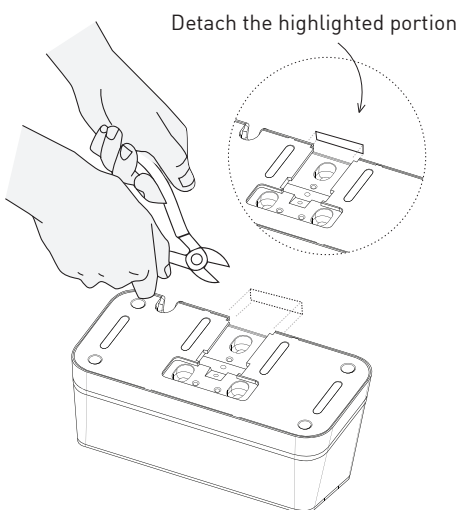

Step 2

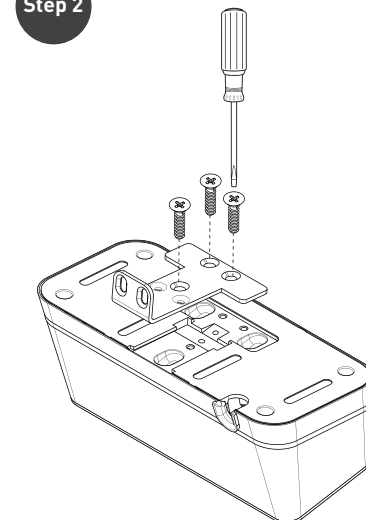

Fix the clamp to the unit using the provided 3 screws.

Step 3

Securely screw the unit onto the table using two (3) screws provided in two different orientations – one above the table and one below the table, as shown in the images. Ensure the table is at least 1/2" thick for proper screw mounting.

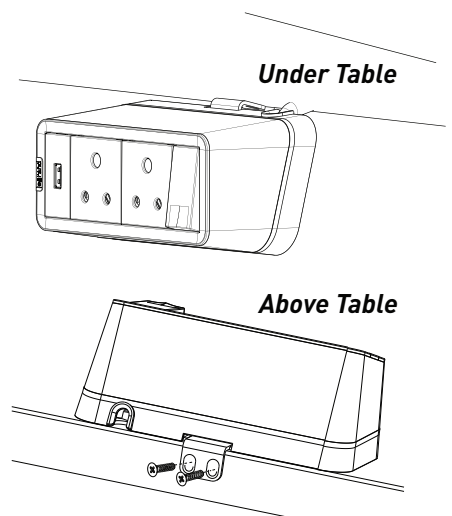

Step 4

Plug the unit into the power supply for use.

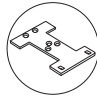

I - CLAMP

Step 1

Start by cutting both edges of highlighted portion in the drawings and gently bend them to detach from the product.

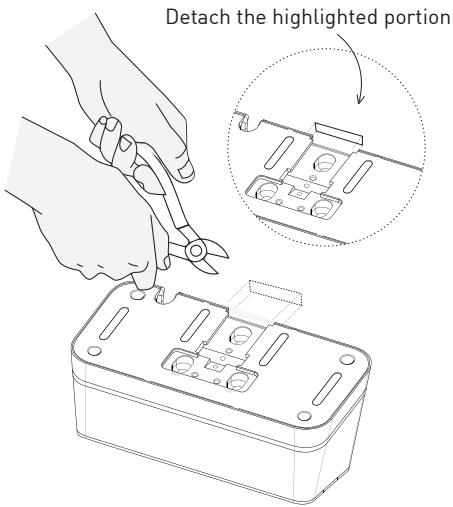

Step 2

Attach the clamp to the unit using the provided 3 screws.

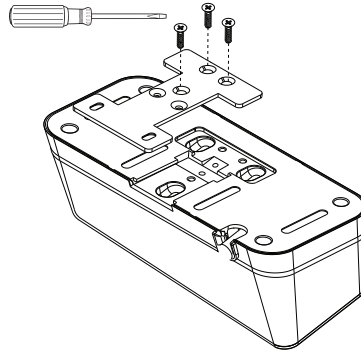

Step 3

Securely screw the unit onto the edge of the table using the two screws. Ensure the table is at least 1/2" thick for proper screw mounting.

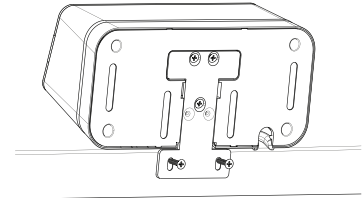

Step 4

Plug the unit into the power supply for operation.

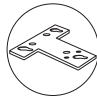
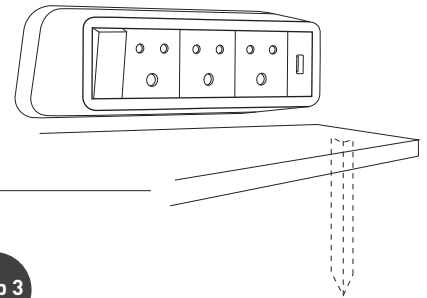

T - CLAMP

Step 1

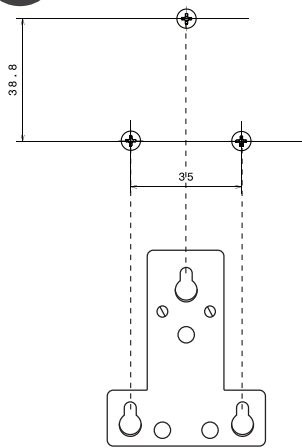

Hold the clamp in your hand and make marks on the walls. Then, tightly screw in the screws according to the marks. Make sure the screws stick out 4 mm from the walls.

Step 2

Fix the clamp to the unit using the 3 provided screws.

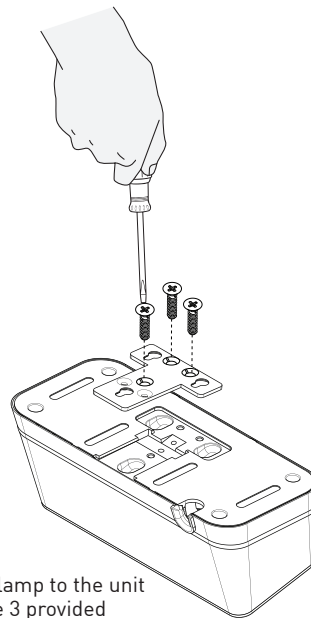

Step 3

Hang the product on the walls by matching the keyholes on the attached bracket with the screws secured to the walls.

Wall Mount

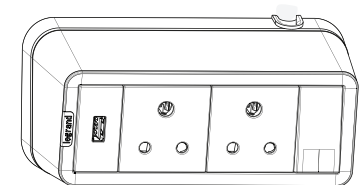

Step 4

Plug the unit into the power supply for use.

Warranty policy

Legrand warrants to the original purchaser that the Products (excluding any third-party products purchased through Legrand, for which no warranties are made) will be free from defects in material and workmanship, under normal use and regular service, and preventative maintenance for a period of 24 months from the date of purchase. Should any failure to conform with this warranty be found during the Warranty Period, you must notify Legrand of your claim within thirty (30) days of discovery, and within the Warranty Period. Your failure to give notice of claims of breach of warranty within the Warranty Period shall be deemed as absolute and unconditional waiver of claims for such defects. Legrand will have no responsibility to honour claims received after the date the applicable Warranty Period expires. The invoice / bill in original must be produced without which warranty claim shall not be entertained.

This warranty does not cover the following:

- Defect caused due to misuse, alteration, faulty installation, faulty electrical systems, negligent maintenance or misapplication of the product.
- Failure of product or components due to any act of nature; lightning strike, floods, hurricanes, tornadoes, etc. beyond the control of human being.
- Legrand does not warrant any third-party products or associated hardware or their performance or suitability for use and application. Such items are provided "as-is".

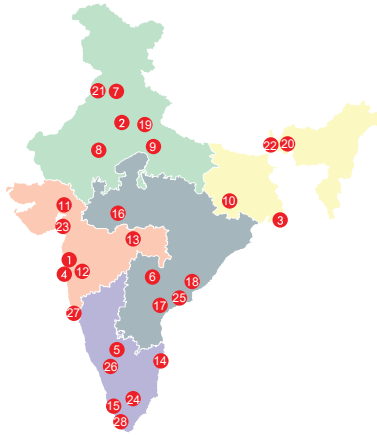

Head offices

- 61 & 62, 6th Floor,
Kalpataru Square, Kondivita Road,
Off Andheri-Kurla Road, Andheri (E),
MUMBAI – 400 059.
Tel.: (022) 3041 6200
Fax : (022) 3041 6201
Website : www.legrand.co.in

Regional sales offices

- B-225, 4th Floor, Okhla Industrial
Area, Phase -1,
NEW DELHI - 110020.
Tel.: (011) 3990 2200, 2699 0046,
(011) 2699 0028 / 29 / 30 / 31
Fax : (011) 2699 0047 **INNOVAL**
- Unit no 1203, Ambuja Eco Centre,
Sector 5, Salt lake,
KOLKATA – 700 091 **INNOVAL**
- C/203, Corporate Avenue, Atul Projects,
Near Mirador Hotel, Chakala,
Andheri - Ghatkopar Link Road,
Andheri – (E), **MUMBAI** – 400 099.
Tel.: (022) 6230 1000 **INNOVAL**
- Ferozes Manor, Situated at 58
Hospital Road, Shivaji Nagar,
BANGALORE – 560 001.
Tel.: (080) 6822 0000 **INNOVAL**
- Prestige Phoenix, 1st Floor,
Next to Lifestyle Building,
Begumpet, **HYDERABAD**,
Telangana - 500 016 **INNOVAL**

Technical assistance from Legrand

Telephonic technical assistance for selection of products, technical information, guidance, wiring diagrams and estimation is now made available to you at each Regional Office. Contact the Technical Officer of Legrand at the following telephone numbers

- New Delhi** : Tel.: (011) 2699 0028, 3990 2200
Kolkata : Tel.: (033) 4021 3535 / 36
Mumbai : Tel.: (022) 6230 1000
Bangalore : Tel.: (080) 6822 0000
Hyderabad : Tel.: (040) 4567 1717

For other places, contact the nearest
Regional / Branch / Area offices

customer.care@legrand.co.in

www.legrand.co.in /Legrand.In @Legrand_IN @Legrand_IN /LegrandIndiaOfficial

Customer Care :



SERVICE. FOR SURE.

1800 103 7700 | www.legrand.co.in | customer.care@legrand.co.in

Branch offices

- Unit No. 203, Tower B Bestech
Business Towers, Sector-66, Mohali,
CHANDIGARH - 160 017.
Tel.: (0172) 5019 008 **INNOVAL**
- Building No-128, Mansarovar Link Road,
Gopalpura Bypass, Mohan Nagar,
Near Ridhi Sidhi Flyover, **JAIPUR** - 302018
Tel.: 0141-2208665 **INNOVAL**
- 209-A, 2nd Floor, Cyber Heights,
Opp. Indira Gandhi Pratishthan,
Vibhuti Khand, Gomti Nagar,
LUCKNOW - 226 010.
Tel.: (0522) 431 9316 **INNOVAL**
- 202 & 203, Sunrise, Forum 100,
Burdwan Compound, Lalpur,
RANCHI - 834 001.
Tel.: (651) 660 5400
- A 101-102, Mondeal Heights,
Besides Novotel Hotel, Sarkhej
Gandhinagar Highway (S G Highway),
AHMEDABAD – 380 015.
Tel.: (079) 6134 0555 **INNOVAL**
- 8th Floor, Pinnacle Park Avenue,
Opp. Law College, Law College Road
Next To German Bakery,
Shivaji Nagar, **PUNE** - 411004.
Tel.: (020) 6729 5601 / 600 **INNOVAL**
- Plot No.95, 2nd Floor, Shreyash
Heights, VIP Road, Ramdaspath,
NAGPUR – 440 010.
Tel.: (0712) 2440 900
- 10 B, Prestige Center Court, Office Block,
Vijaya Forum Mall, #183, N.S.K. Salai,
Vadapalani, **CHENNAI** – 600 026.
Tel.: (044) 6612 2800 **INNOVAL**
- J. B. Manjooran Estate,
Door No. 50/1107 A9, 3rd Floor,
Bye Pass Junction, Edappally,
COCHIN – 682 024.
Tel.: (0484) 6604 700 **INNOVAL**
- 204-205, Megapolis Square,
579, M G Road,
INDORE – 452 001.
Tel.: (0731) 4999 891
- MF-2, Datta's Lords House,
Jammie Chettu Street, Mogalrajapuram,
VIJAYAWADA – 520 010.
Tel.: (0866) 248 2393/6393
- Plot No. 359, Saheed Nagar,
2nd Floor,
BHUBANESWAR – 751 007.
Tel.: (0674) 254 0623
- Unit - 1 & 2, Vijay Park,
Main Chakrata Road,
DEHRADUN- 248 001.
Uttarakhand.
Tel.: (0135) 661 6100 **INNOVAL**
- House No. 97, Ground Floor,
Rajgarh Main Road,
Opp. City Heart Nursing Home,
GUWAHATI – 781 007.

Area offices

- Cabin No. 9, 2nd Floor,
Madhok Trade Centre,
Madhok Complex, Ferozpur Road,
LUDHIANA – 141 001.
Tel.: (0161) 277 0301
- 94, Udhm Singh Sarani,
Ground Floor, Ashrampara,
SILIGURI – 734 001.
Tel.: (353) 264 1067
- A-207, Universal Business
Center, Near Madhuvan Circle,
L.P. Savani Road, Adajan,
SURAT - 395 009.
Tel.: (0261) 263 3861 **INNOVAL**
- Aparna Towers, 1st Floor, 2/3,
Bypass Road,
MADURAI – 625 010.
Telefax : (0452) 230 8414
- 43-9-205, 3rd Floor, Plot No. 10,
Subbalakshmi Nagar,
Opp. More Super Market,
VISAKHAPATNAM - 530 016.
Tel.: (0891) 273 5652 / 2739363 **INNOVAL**
- B-5, 1st Floor, Thirumalai Towers,
723, Avanashi Road,
COIMBATORE – 641 018.
Tel.: (0422) 668 3200 **INNOVAL**
- 515 & 516, Gera Imperium Grand,
Patto centre ,
Panaji **GOA** – 403 001 **INNOVAL**
- 1st Floor, Cordial Bharathi,
Nanthancodu, **THIRUVANTHAPURAM**,
KERALA- 695 003 **INNOVAL**



Scan QR Code